

DANUBE RIVER ROMAI PROMENADE: DESIGNING WITH DYNAMIC FORCES

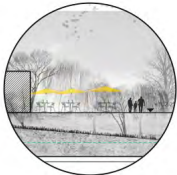

NATURAL SHORE



BUILT SHORE

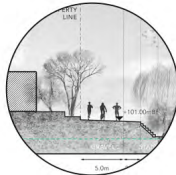

GATEWAY

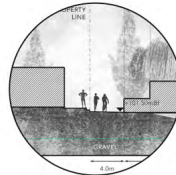

CONSTRAINED PATH

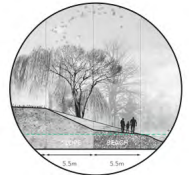

RIVER ACCESS

EXISTING TYPOLOGIES

PROJECT CONTEXT

The political atmosphere for urban development and public space projects in **Budapest** has reached a **critical turning point** and a **paradigm shift** is needed. Heavy top-down government processes which **ignore** the will and **needs of citizens** can be seen in recent projects such as **Varosliget** and **Romai Part**. This approach represents a larger ideology which **threatens** social and ecological democracy.

Design work is based on a **typology method** in which related yet distinct categories were identified for the promenade based on diverse **site analyses**. These typologies were then used to categorize a **series of design solutions** informed by research and reference projects. The result is a **Design Matrix** which outlines possible design solutions for each typology situation. In this way, the matrix can be used to **solve design challenges** for the entire three kilometer shoreline in a **flexible way** by responding to unique situations along the promenade while still producing a **unified design character**.

The design solutions proposed in this work are ultimately searching for better ways of **harmonizing social and ecological systems**.

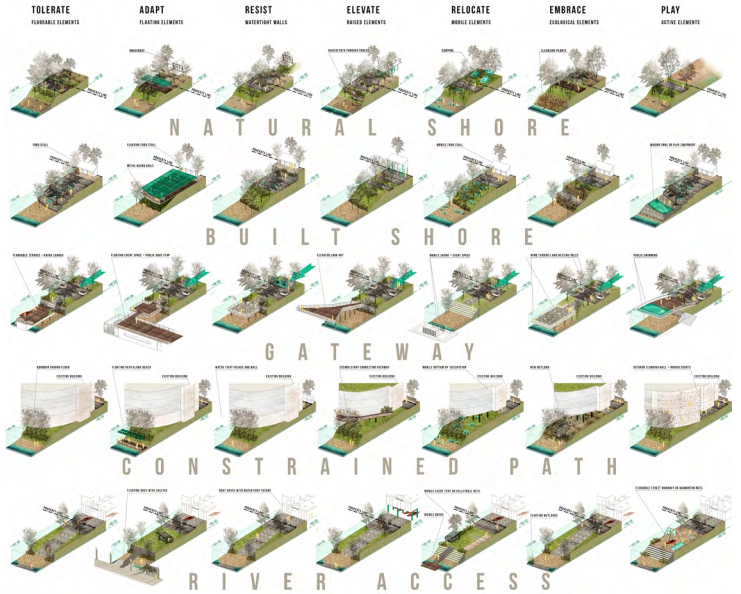

DESIGN MATRIX



PATIO TERRACES

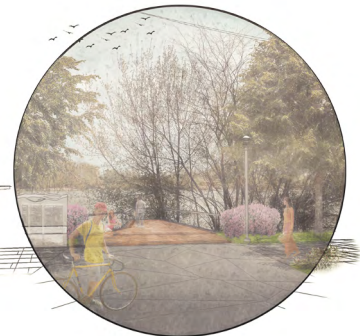

FLOATING LOOKOUT



UJPESTI VASÚTI BRIDGE

BUDA HILLS

NEPLIGET

DESIGN SITE I

DESIGN SITE II

DESIGN SITE III